

ACTICUF™ INSIGHT: FREQUENTLY ASKED QUESTIONS

Q: WILL PEOPLE NOTICE I'M WEARING THE ACTICUF™ POUCH?

A: Rest assured, the ActiCuf™ Compression Pouch was engineered and carefully tested with this very concern in mind. Its unique shape forms naturally to your body. Plus it is small enough to carry with you confidentially - even in your pocket!

Q: HOW LONG CAN I WEAR THE ACTICUF™ POUCH?

A: One ActiCuf™ Compression Pouch can be used all day, however it will need to be repositioned every three to four hours. Though rare, instances of skin irritation may occur with prolonged exposure to urine. The ActiCuf™ Pouch should not be worn while sleeping.

Q: CAN I USE A PUBLIC URINAL WITH THE ACTICUF™ POUCH?

A: Absolutely! Because the ActiCuf™ Pouch is so discreet, you can take it off and put it on again quickly and effortlessly without anyone noticing.

Q: IS A PRESCRIPTION REQUIRED?

A: No. Any male affected by urinary incontinence who desires a renewed lifestyle is invited to experience the freedom of the ActiCuf™ Compression Pouch. When seeking reimbursement however, a prescription is required.

Q: WHO DO I CONTACT IF I HAVE QUESTIONS REGARDING THE ACTICUF™ POUCH?

A: The dealer listed below can answer your questions and help you decide if ActiCuf™ is right for you.



MediSpera Ltd
London, UK
+44 (0)20 8868 3163
@medispera
info@medispera.com
www.medispera.com



PROTECTIVE
ABSORBENT SHIELD

UNIQUE SHAPE AND SIZE IS
DISCREET AND EASY TO REMOVE

IT'S A NEW WAY OF LIVING. A WHOLE NEW YOU.

The breakthrough ActiCuf™ Compression Pouch is a disposable, undetectable pouch designed to help men manage light to moderate urinary incontinence. When placed on the penis, the padded closure gently presses down on the urethra to control urinary flow. Any leakage is immediately absorbed by the pouch, so you can enjoy an active lifestyle once more.

PADDED CLOSURE
COMFORTABLY PREVENTS LEAKAGE

The ActiCuf™ Compression Pouch is discreet under clothing, and its sleek, portable design makes using public urinals a worry-free experience. Removing and replacing the ActiCuf Pouch is fast and easy.

HERE'S HOW TO USE:

1. Hold the ActiCuf™ Pouch with your thumb and forefinger.
2. Squeeze the ActiCuf™ closure until the end is completely open and the round in shape. Insert penis as far as possible into the opening of the device.
3. Release pressure so the ActiCuf™ closure fits snugly around the penis. Adjust it as necessary to achieve the greatest comfort and ultimate leakage protection.
4. Using public urinals is convenient again. Removing the ActiCuf™ Pouch is simple:
 - Squeeze the base of the penis to stop any urinary flow.
 - Remove the ActiCuf™ to urinate.
 - Replace the ActiCuf™ by repeating steps 1-3 above.

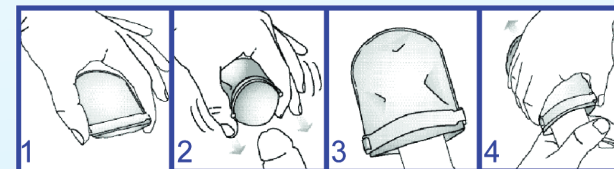

TIP: Although the ActiCuf™ Compression Pouch is engineered for the greatest ease of use, it's not uncommon for accidents to occur. Keep an extra ActiCuf™ Pouch close at hand in case of sudden leaks until you learn to take it on and off like a pro.

